

Business and Finance

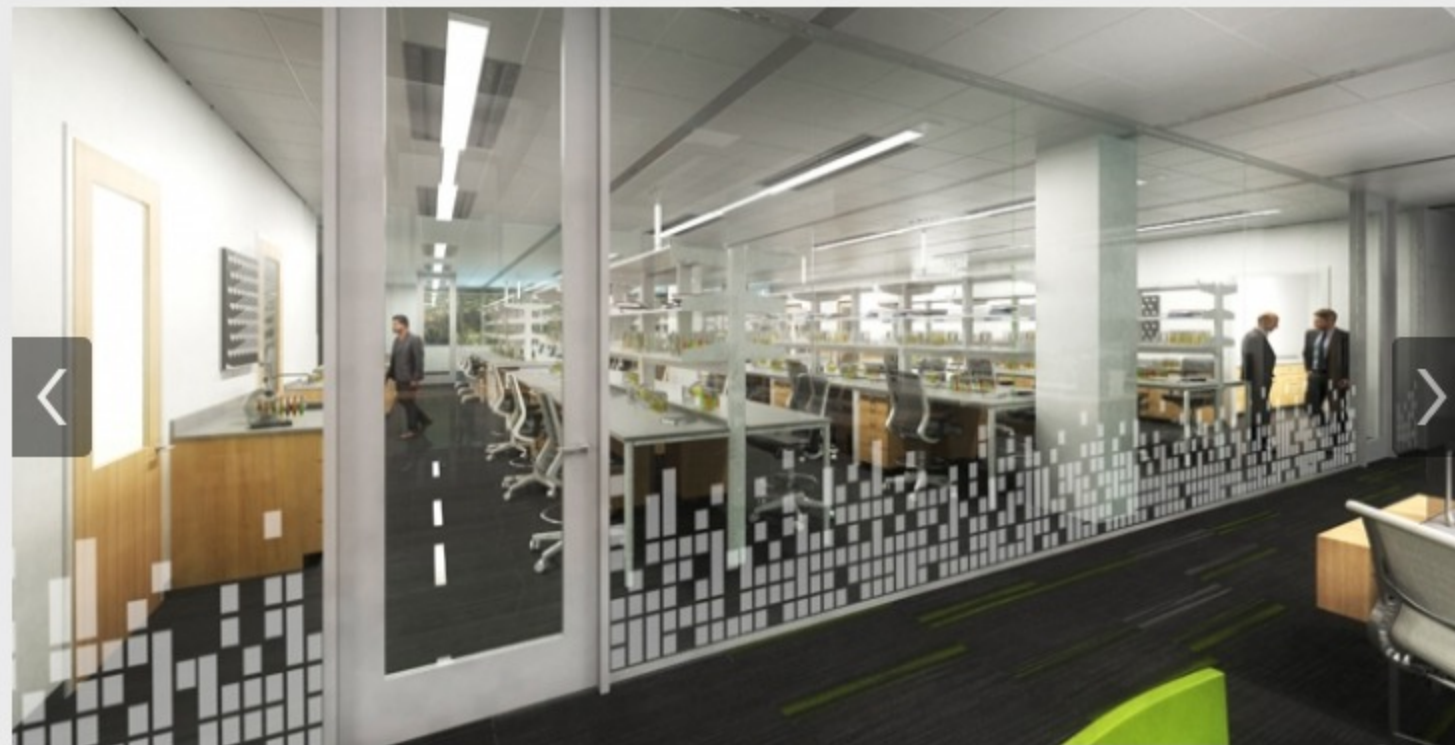

Construction

Select a project

Facilities | Construction | Biodesign C

Biodesign C

Biodesign C webcam

This new, multi-functional research facility will meet the university's growing need for additional laboratory space to secure and perform high-quality research.

Biodesign Institute Building C will include state-of-the-art research support space designed specifically to promote and enable the creation of cutting-edge research clusters. The facility's design will leverage the university's investment to maximize the opportunities for research growth.

Biodesign C, which will be located just to the east of Biodesign B on the Tempe campus, is a five-story-plus-basement complex. The building will include laboratories, lab casework and office layouts that will feature maximum flexibility, adaptability, and expansion based on needs.

Biodesign C will house research from the College of Liberal Arts and Sciences, Ira A. Fulton Schools of Engineering, and the Biodesign Institute. It will provide high-quality wet lab space for chemistry, engineering, and the biological sciences.

The building is designed to meet specifications for LEED Silver at a minimum, with intentions of achieving a higher certification.

Campus:	Tempe
Gross Square Footage:	188,000
Total project cost:	\$120,000,000
Architect:	ZGF Architects LLP/BWS Architects
Construction team:	McCarthy Building Companies, Inc.
Project start date:	June 2016
Project end date:	June 2018

ASU Business & Finance

Office of the Executive Vice President,
Treasurer and Chief Financial Officer

[News](#)

[Page contact](#)

[Site map](#)

ASU is #1 in the U.S. for Innovation

